



2016

Septodont Products Catalogue

- Pain Control
- Endodontics
- Restorative & Prosthetic
- Periodontology & Surgical
- Impression
- Preventive Care
- Infection Control





**With over 80-year
experience dedicated to
developing and
manufacturing innovative
products for dental
professionals**

Since its founding 1932 by Annie & Nestor Schiller, Septodont has developed, manufactured and distributed a wide range of high quality products for dental professionals around the world.

Thanks to its long tradition of innovation and quality, Septodont has been, and still is in the forefront of the dental pharmaceutical industry. From local anaesthetic cartridges, topical gels, dental needles, obturation powders & pastes to innovative restorative solutions, Septodont can meet practitioners needs in pain control, endodontics, restorative dentistry, infection control and more.

Today, Septodont is a group with over 1,000 employees, six manufacturing facilities across France, North America and India, and an international distribution network, all dedicated to serving the needs of dental professionals in more than 150 countries.

**Production expertise
approved by government
health agencies and dental
professionals on five
continents**

Dentists around the world know that they can count on the consistent quality of Septodont. Their trust has made Septodont the world leader in local anaesthetics, being used in 500 million of dental injections per year throughout the world.

Our production facilities are approved worldwide, fulfilling requirements of countries and continents renowned for their pharmacopeias, such as Europe, Japan and the United States and meeting the most stringent quality standards.



**Hundreds of market
authorisations
worldwide**

Septodont's products have been tested and approved by the relevant authorities in every country in which they are marketed, in line with the most demanding national and international standards.

This means that a Septodont product has potentially undergone hundreds of registrations or certifications throughout the world: a clear sign of its quality and reliability.

When using a Septodont product, the practitioner can feel confident knowing that his choice has benefited from the sum of worldwide requirements in terms of both health and safety.

**Ever present,
ever listening**

It is part of Septodont's ethos to maintain close relationships with professionals in the dental world. Septodont works in collaboration with panels of dentists, attends the major international industry events, stays up-to-date with the latest scientific developments and develops partnerships with recognised opinion leaders and pre-eminent universities.

As a result, Septodont has developed and marketed products which have brought many benefits to practitioners and their patients. As the worldwide leader in pain control, Septodont has designed and launched an innovative product line covering the whole anaesthesia procedure: local anaesthetics, needles, injection devices... Most recently, Septodont introduced Septoject Evolution, a breakthrough dental needle, providing greater control and reduced discomfort. Beyond the field of pain control, Septodont has lately developed highly innovative products in periodontology & surgical with the launch of R.T.R., a β -tricalcium phosphate bone grafting material, in restorative dentistry with the launch of N'Durance®, a range of breakthrough composite solutions with the exclusive Nano-Dimer technology, and in the field of impression with the introduction of Racegel, a unique gingival preparation gel. More recently, Septodont launched Biodentine™, the 1st dentine substitute with both restorative and endodontic applications.



07

Pain Control

- Topical Anaesthetics
- Injectable Anaesthetics
- Needles

17

Endodontics

- Cleaning - Preparation
- Obturation
- Desobturation
- Dentine Substitute
- Auxiliary Endodontics

25

Restorative & Prosthetic

- Dentine Substitute
- Cavity Liners
- Temporary Restorative
- Alloys
- Composites

33

Periodontology & Surgical

- Haemostatics
- Bone treatment
- Periodontology

39

Impression

- Gingival Preparation
- Impression materials

45

Preventive Care

- Oral Hygiene
- Tooth Protection
- Scaling & Polishing

49

Infection Control

- Instrument Disinfection
- Hand Hygiene & Disinfection
- Impression Disinfectant

DO YOU KNOW THAT?

SEPTANEST⁽¹⁾
IS THE MOST **TRUSTED**
BRAND WORLDWIDE⁽²⁾...

...THANKS TO A STRONG
COMMITMENT TO THE
HIGHEST QUALITY



(1) Septanest is also sold in some countries under the names Septocaine® or Medicaine®

(2) Among dental injectable local anaesthetics, with 150 million cartridges used every year

Pain Control

Dental professionals throughout the world not only use over 500 million cartridges of Septodont local anaesthetics every year but also trust Septodont for the full range of products used in anaesthesia procedures: topicals, needles and syringes.

Our pain control line has been designed to serve the needs of dental professionals in more than 120 countries, offering the largest choice of molecules, pharmaceutical forms and pack sizes.

Our expertise in manufacturing combined with the approval of the health authorities around the world is a guarantee of the quality and reliability of our products, making Septodont your best partner in pain control.

08

Topical Anaesthetics

Pharmaethyl
Xylonor Gel
Xylonor Spray

09

Injectable Anaesthetics

Septanest 1:100,000
Septanest 1:200,000
Scandonest 2% Special
Scandonest 3% Plain
Lignospan Special

12

Needles

Septoject
Septoject XL
Septoject Evolution
Ultra Safety Plus



Pain Control

Topical Anaesthetics

CE 0459

Pharmaethyl

Tetrafluoroethane cryo-anaesthetic spray



Indications

Production of topical cryo-anaesthesia in the oral cavity, prior to the extraction of deciduous or periodontally compromised teeth or to the lancing of abscesses

Vitality test

Features and Benefits

- Tetrafluoroethane has a greater cryo-anaesthetic activity than ethyl chloride
- Quicker and deeper cooling action to improve efficacy

Presentation

150 ml spray bottle with metered dose

Xylonor Gel

5% lidocaine analgesic gel



Product License N°: PL 08313 / 0027 (P)
See API on page 55.

Indications

Topical analgesia of oral mucosa before anaesthetic injection

Temporary pain relief during short and simple dental procedures

Gag reflex elimination when performing radiographs or impressions

Features and Benefits

- Gel consistency prevents wash away to improve activity
- Fast acting, gives anesthesia within 2-5 mns
- Improves the patient's comfort during many procedures
- Mint flavoured gel

Presentation

15 g tube

Xylonor Spray

15% lidocaine analgesic solution in a metered aerosol



Product License N°:
PL 08313 / 0032 (P)
See API on page 55.

Indications

Production of topical anaesthesia and disinfection of the mucous membrane in the buccal cavity, especially:

- before the performance of a local or nerve block injection
- prior to the extraction of mobile, deciduous or permanent teeth
- prior to the adjustment and fitting of crowns and bridges or the adjustment of bands in orthodontic treatments
- prior to the lancing of sub-mucosal abscesses
- prior to scaling

Features and Benefits

- Easy dosage of active ingredient thanks to the metered spray
- Precise and safe application with the included nozzle
- Fast acting, gives anesthesia within 2-5 mns and lasts 10-20 mns

Presentation

Metered aerosol dose
containing 36 g of solution

Septanest 1:100,000

4% articaine with 1:100,000 epinephrine injection solution

Indications

Local or loco-regional dental anaesthesia in patients of at least 4 years old

Features and Benefits

- Septanest 40 mg/ml plus adrenaline 0.01 mg/ml (1/100 000) is particularly appropriate for procedures of longer duration and when there is a risk of significant bleeding into the operative field
- Fast onset to avoid delay before effective analgesia is achieved
- No-methylparaben formulation to avoid allergic reactions on sensitive patients
- 100% latex-free
- Terminal sterilization of product/cartridges, the Gold Standard method for Health Authorities around the world
- Milar label covered glass cartridges to minimize risk of injury in the event of a cartridge breakage



Product License N°: PL 08313 / 0039 (P.O.M)
See API on page 54.

Presentation

Box containing 5 blisters of
10 x 2.2 ml glass cartridges

Septanest 1:200,000

4% articaine with 1:200,000 epinephrine injection solution

Indications

Local or loco-regional dental anaesthesia in patients of at least 4 years old

Features and Benefits

- Septanest containing 1/200 000 epinephrine should be preferred as it reduces the risk of excessive uptake of Septanest into the systemic circulation
- No-methylparaben formulation to avoid allergic reactions on sensitive patients
- 100% latex-free
- Terminal sterilization of product/cartridges, the Gold Standard method for Health Authorities around the world
- Milar label covered glass cartridges to minimize risk of injury in the event of a cartridge breakage



Product License N°: PL 08313 / 0038 (P.O.M)
See API on page 55.

Presentation

Box containing 5 blisters of
10 x 2.2 ml glass cartridges

Pain Control

Injectable Anaesthetics

Scandonest 2% Special

2% mepivacaine with 1:100,000 epinephrine injection solution



Product License N°: PL 08313 / 0026 (P.O.M)
See API on page 54.

Indications

Local or loco-regional dental anaesthesia

Features and Benefits

- Mepivacaine is the preferred molecule for short procedures and periodontal treatments
- No-methylparaben formulation to avoid allergic reactions on sensitive patients
- Terminal sterilization of product/cartridges, the Gold Standard method for Health Authorities around the world
- 100% latex-free

Presentation

Box containing 5 blisters of
10 x 2.2 ml glass cartridges

Scandonest 3% Plain

3% mepivacaine injection solution

Indications

Local or loco-regional dental anaesthesia
(and chiropody procedures)

Features and Benefits

- Formulation without vaso-constrictor for specific medical situations
- No-methylparaben formulation to avoid allergic reactions on sensitive patients
- Terminal sterilization of product/cartridges, the Gold Standard method for Health Authorities around the world
- 100% latex-free

Presentation

Box containing 5 blisters of
10 x 2.2 ml glass cartridges



Product License N°: PL 08313 / 0023 (P.O.M)
See API on page 54.

Lignospan Special

2% lidocaine with 1:80,000 epinephrine injection solution

Indications

Local or loco-regional dental anaesthesia

Features and Benefits

- No-methylparaben formulation to avoid allergic reactions on sensitive patients
- Terminal sterilization of product/cartridges, the Gold Standard method for Health Authorities around the world
- 100% latex-free

Presentation

Box containing 5 blisters of 10 x 1.8 ml glass cartridges
Box containing 5 blisters of 10 x 2.2 ml glass cartridges



Product License N°: PL 08313 / 0019 (P.O.M)
See API on page 54.

Maximum Dosage

Product	Septanest 1:100,000	Scandonest 2% Special	Scandonest 3% Plain	Lignospan Special
	Septanest 1:200,000			
mg/lb Body Wt.	3.2	3.0	3.0	3.2
Maximum Dosages	440 mg	132 mg	198 mg	132 mg
Anaesthetic per 2.2 ml Cartridge	88 mg	44 mg	66 mg	44 mg
Maximum Number of 2.2 ml Cartridges	5	3	3	3

Pain Control

Needles

Septoject

Sterile single use dental needle

CE 0459

Indications

Routine administration of dental local anaesthetics

Features and Benefits

- Less trauma to the tissue achieved through a triple-bevel needle, a polished & siliconised canula and an excellent flexibility of the needle
- High grade surgical stainless steel tubing to reduce risk of breakage



Presentation

Box of 100 sterile single use dental needles



Product Range

INFILTRATION

Gauge	Length	Colour code
27G/0.40 mm	Short - 25 mm	
30G/0.30 mm	Short - 25 mm	

TRUNCAL

Gauge	Length	Colour code
27G/0.40 mm	Long - 35 mm	

Septoject XL

Sterile single use dental needle with enlarged bore

CE 0459

Indications

Routine administration of dental local anaesthetics

Features and Benefits

- With enlarged bore (43% wider than the one of a standard needle) to reduce level of pressure during injection, thus leading to less pain for the patient
- Less trauma to the tissues achieved through a triple-bevel needle, a polished & siliconised canula and an excellent flexibility of the needle
- High grade surgical stainless steel tubing to reduce risk of breakage
- With bevel indicator to assist in orientating the bevel during injection

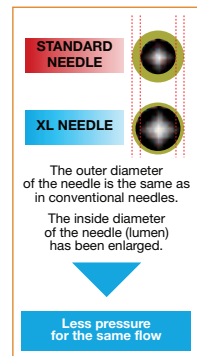

Presentation

Box of 100 sterile single use dental needles



Product Range

INTRALIGAMENTARY

Gauge	Length	Colour code
30G/0.30 mm	X Short - 10 mm	

INFILTRATION

Gauge	Length	Colour code
27G/0.40 mm	Short - 25 mm	
30G/0.30 mm	Short - 25 mm	

TRUNCAL

Gauge	Length	Colour code
27G/0.40 mm	Long - 35 mm	

Pain Control

Needles

Septoject Evolution

CE 0459

Sterile single use dental needle, with scalpel-designed bevel

Indications

Routine administration of local dental anaesthetics by infiltration or intraligamentary injections

Features and Benefits

- Scalpel-designed bevel cuts rather than tears tissue requiring less force for the needle insertion
- Less tissue is displaced resulting in reduced discomfort for the patient
- The centred position of the bevel results in less deflection and greater control for the dentist
- High grade surgical stainless steel tubing to reduce risk of breakage
- 2 bevel marks on hub for optimal use

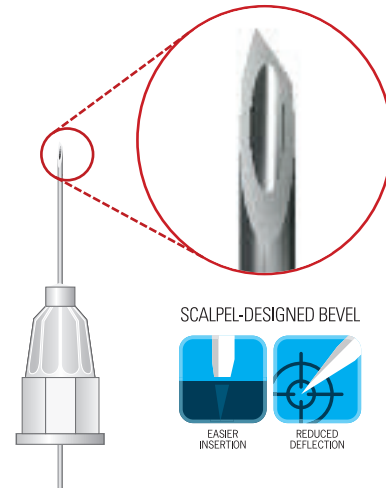

Presentation

Box of 100 sterile single use dental needles





Product Range

INTRALIGAMENTARY

Gauge	Length	Colour code
30G/0.30 mm	X Short - 9 mm	

INFILTRATION

Gauge	Length	Colour code
27G/0.40 mm	Short - 25 mm	
30G/0.30 mm	Short - 25 mm	

Ultra Safety Plus

Needle stick injury prevention device

CE 0086

Indications

Routine administration of dental local anaesthetics

Features and Benefits

- Sterile, single use injection system, specially designed to prevent needle stick injuries allows both auto or manual aspiration techniques
- No recapping necessary, conforms to new UK legislation on safer sharps regulations
- With bevel indicator to assist in orientating the bevel to the bone
- With transparent barrel to allow visualization of aspiration



Instructions for use

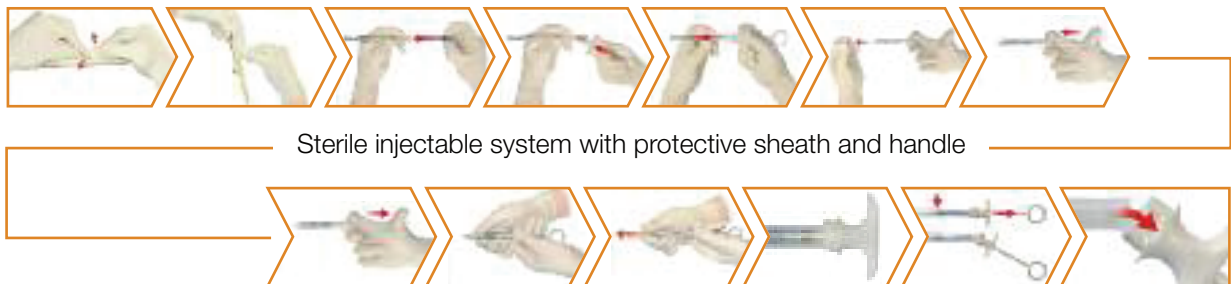

Presentation

Box of 100 needles individually packed and sterilized
+ 1 autoclavable handle

Box of 50 needles individually packed and sterilized plus
50 disposable sterile handles

Box of 50 disposable sterile handles

Product Range

Gauge	Length	Colour code
27G/0.40 mm	Short - 25 mm	
27G/0.40 mm	Long - 35 mm	
30G/0.30 mm	X Short - 10 mm	
30G/0.30 mm	Short - 25 mm	



Endodontics

BioRoot™ RCS is the new bioactive mineral Sealer with outstanding sealing properties.

The new root canal filler with high purity mineral formulation combines the essential properties for a tight and permanent seal.

- **High seal**

Hydrophilic properties ensure a hermetic seal without shrinking and reduces the risks of voids.

- **Antimicrobial effect**

Calcium hydroxide release creates a favorable alkaline environment and prevents bacterial growth leading to clinical failures.

- **Peri-apical healing**

The composition of high purity mineral formulation stimulates bone regeneration and promotes periodontal healing.

- **Easy obturation and follow-up**

time-saving and easy application used with any cold obturation technique with a optimized working (>10 minutes) and setting time (< 4 hours).

18

Cleaning - Preparation

Canal +	Endocal
Largal Ultra	R4
Parcan	

20

Obturation

BioRoot™ RCS
Endomethasone N/Endomethasone Liquid
Endomet Plain

22

Desobturation

Endosolv E
Endosolv R

23

Dentine Substitute

Biodentine™

23

Auxiliary Endodontics

Endoperox kit



Endodontics

Cleaning - Preparation

CE 0459

Canal+

EDTA gel



Presentation

5 g syringe, 15 x applicator tips

Indications

Root canal preparation
Instrument lubrication

Features and Benefits

- Lubricating water-soluble gel
- Clings to instruments and facilitates mechanical preparation
- Makes mechanical reaming easier and faster as EDTA chelates mineral components of dentine
- Optimises cleaning of the root canal if used in combination with Parcan irrigation solution, thanks to the effervescent properties of carbamide peroxide

Largal Ultra

15% EDTA solution

CE 0459

Indications

Chelating agent for root canals

Features and Benefits

- EDTA chelates mineral components of dentine, making mechanical reaming easier and faster
- Contains cetrimide which has a bactericidal action and reduces surface tension, thus increasing dentine penetration
- Non-toxic and non-caustic, thus harmless for the periapical tissues
- Eliminates smear layer resulting from use of endodontic instruments



Presentation

125 ml bottle

Parcan

3% stabilised solution of sodium hypochlorite

CE 0459



Indications

Root canal irrigation

Features and Benefits

- Ready to use solution, specially formulated for use in endodontics
- Buffered and stabilised formulation, that maintains the solution properties throughout its shelf life
- Facilitates reaming through dissolution of the organic content of the root canal system
- Wide bactericidal spectrum, including the majority of endodontics pathogens

Presentation

250 ml perfusion-type flask

Endocal

52% calcium hydroxide gel

CE 0459

Indications

Root canal decontamination
Temporary root canal filling

Features and Benefits

- Non-setting gel for easy placement in the root canal
- Bactericidal action obtained from calcium hydroxide high pH level of 12
- Methylcellulose-based formulation for easy removal before final obturation
- Radiopaque for short and long term follow up

Presentation

4 g syringe, 30 x applicator tips



R4

Chlorhexidine digluconate solution

CE 0459



Indications

Root canal disinfection

Features and Benefits

- Low surface tension to ensure penetration of solution into dentinal tubules
- Large spectrum and rapid action against root canal pathogens (tested on 13 anaerobic bacterial strains)
- Non irritant formula, well tolerated by periapical tissues
- Long lasting & persistent effect during 48 hours after application

Presentation

13 ml bottle

Indications

Permanent root canal obturation

Features and Benefits

- Latest generation bioactive root canal sealer based on high purity mineral chemistry
- High seal ensured through a tight gutta percha/sealer/dentin interface and dentin structure mineralization
- Antimicrobial properties due to calcium hydroxide release to reduce the risk of treatment failures
- Bioactive properties to promote peri-apical healing
- Fast and easy placement in the root canal with any cold obturation technique
- Radiopaque for easy follow-ups
- Easily removed from the root canal in case a retreatment is necessary

Instructions for use

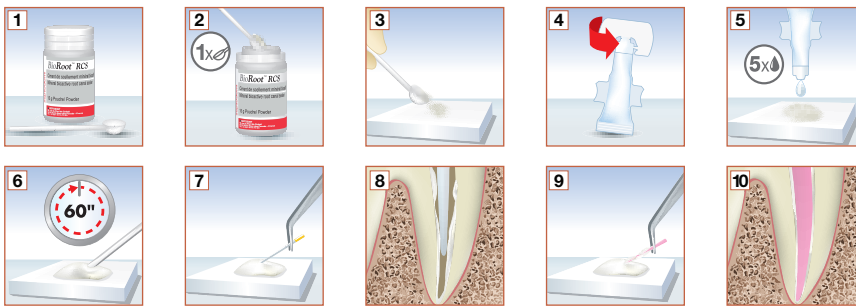

Presentation

1 x 15 g powder bottle,
35 x single dose containers



Endomethasone N/Endomethasone Liquid

Zinc oxide eugenol-based endodontic cement

CE 0459

Indications

Permanent root canal sealer

Features and Benefits

- Radiopaque for easy short & long-term follow up
- Neither resorbable after setting nor retractable to allow stable root canal obturation
- Antiseptic and anti-inflammatory properties to reduce post-operative flare ups
- Conventional powder liquid presentation to adjust the cement viscosity to the obturation technique

Presentation

Powder: 1 x 14 g powder bottle, 1 x measuring spoon

Powder: 3 x 14 g powder bottle, 1 x measuring spoon

Liquid: 10 ml bottle



Endomet Plain

Zinc-Oxide-Eugenol endodontic cement

CE 0459

Indications

Permanent root canal sealer

Features and Benefits

- Zinc-oxide eugenol-based root canal sealer compatible with all endodontic obturation techniques
- Radiopaque for easy follow up
- Dimensionally stable and non-resorbable for durable obturation
- Cement viscosity can be adapted to preferred obturation technique with the conventional powder liquid presentation

Presentation

Powder: 1 x 14 g powder bottle, 1 x measuring spoon

Liquid: 10 ml bottle



Endodontics

Desobturation

CE 0459

Endosolv E

Tetrachloroethylene solution



Indications

Root canal desobturation

Features and Benefits

- Helps to remove zinc-oxide eugenol-based root canal sealers
- High softening potency for a time saving and efficient desobturation
- Reduces risks associated with use of power driven instruments during mechanical desobturation

Presentation

13 ml bottle

CE 0459

Endosolv R

Formamid solution

Indications

Root canal desobturation

Features and Benefits

- Helps to remove phenolic resin-based root canal sealers
- High softening potency for a time saving and efficient desobturation
- Reduces risks associated with use of power driven instruments during mechanical desobturation

Presentation

13 ml bottle



Biodentine™

Bioactive Dentine Substitute

CE 0459

Indications

In the root: root and furcation perforations, internal/external resorptions, apexification, retrograde surgical filling

See p. 26 for crown indications

Features and Benefits

- Versatile usage: endodontic repair and restorative procedures
- Reactionary dentine genesis for pulp vitality preservation
- Natural micro mechanical anchorage for excellent sealing properties without surface preparation and for post operative sensitivity elimination
- Similar mechanical properties and mechanical behaviour as human dentine for similar stress distribution
- 3.5 mm aluminium radiopacity for easy short and long term follow-up



ACTIVE
BIOSILICATE
TECHNOLOGY

Instructions for use

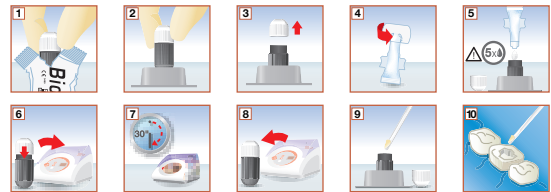

Presentation

15 x capsules + 15 x single-dose containers

Endoperox Kit

100% carbamide peroxide

CE 0459



Indications

Treatment of discoloured non vital teeth

Features and Benefits

- Progressive whitening action thanks to slow degradation of carbamide peroxide into hydrogen peroxide
- Peroxide-based powder with bleaching, bactericidal and detergent actions
- Presented in powder to customize dosage of active ingredients for specific applications

Presentation

5 g bottle of powder, 5 ml bottle of glycerol measuring spoon





Restorative & Prosthetic

Bioactive Dentine Substitute

Biodentine™ delivers unprecedented benefits to clinicians:

- **Preservation of pulp vitality:** Biodentine™ stimulates the pulp cells to build tertiary dentine and form dentine bridges to promote pulp healing.
- **Prevention of clinical failures:** Biodentine™ naturally infiltrates the dentine tubules to ensure long lasting outstanding sealing properties.
- **Ultimate dentine substitute:** Biodentine™ is easy to use and is the closest material to human dentine.
- **Single session restoration:** Bond the composite onto Biodentine™ in the same visit.

26

Dentine Substitute

Biodentine™

27

Cavity Liners

Calcupulpe

27

Temporary Restorative

Cimpat LC
Cimpat N/Cimpat Pink
Cimpat S

28

Alloys

Securalloy
Septalloy NG 70

30

Composites

N'Durance®
N'Durance® Dimer Flow



Restorative & Prosthetic

Dentine Substitute

Biodentine™

Bioactive Dentine Substitute

CE 0459

Indications

In the crown: temporary enamel restoration, permanent dentine restoration, deep or large carious lesions, deep cervical or radicular lesions, pulp capping, pulpotomy

See p. 23 for crown indications

Features and Benefits

- Versatile usage: endodontic repair and restorative procedures
- Reactionary dentine genesis for pulp vitality preservation
- Natural micro mechanical anchorage for excellent sealing properties without surface preparation and for post operative sensitivity elimination
- Similar mechanical properties and mechanical behaviour as human dentine for similar stress distribution
- 3.5 mm aluminium radiopacity for easy short and long term follow-up

Instructions for use

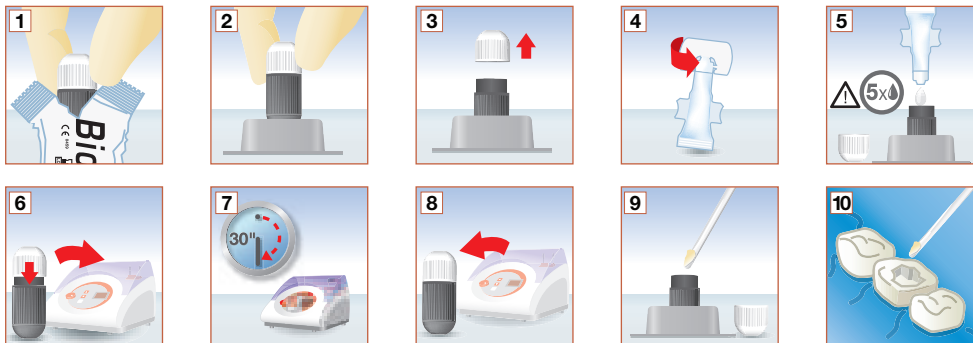

Presentation

15 x capsules + 15 x single-dose containers



Restorative & Prosthetic

Cavity Liners & Temporary Restorative

Calcipulpe

Calcium hydroxide paste

CE 0459

Indications

Pulp capping
Cavity liner

Features and Benefits

- Calcium hydroxide protects the pulp and helps formation of tertiary dentine
- Radiopaque for short and long term follow up
- Comes in a ready to use syringe with disposable applicators for convenience and prevention of cross contamination

Presentation

3 x 1.7 g syringe, 15 x applicator tips



Cimpat LC

Light curing temporary filling material

CE 0459



Presentation

2 x 4 g syringe

Indications

Temporary restoration for inlay/onlay preparations

Features and Benefits

- Remains resilient after curing for improved patient's comfort between appointments
- Easy removal without use of rotary instruments to avoid modification of inlay/onlay preparations

Cimpat N/Cimpat Pink

Temporary filling paste

CE 0459

Indications

Temporary restoration

Features and Benefits

- Adheres to dentine, expands slightly during setting and hardens rapidly to ensure hermetic seal
- Improved mechanical properties for longer lasting temporary restoration



Presentation

25 g glass jar

Restorative & Prosthetic

Temporary Restorative & Alloys

Cimpat S

Temporary filling paste

CE 0473



Indications

Temporary restoration

Features and Benefits

- Presented in convenient syringe to facilitate dispensing and avoid cross contamination
- Adheres to dentine, expands slightly during setting, hardens rapidly to ensure hermetical seal

Presentation

4 x 7.5 g syringe

Securalloy

Low mercury content amalgam

CE 0459

Indications

Restoration of posterior teeth
Core build up material

Features and Benefits

- Non-gamma 2, zinc-free formulation for improved corrosion resistance
- High Copper Single Composition, spherical particles for easy handling and fast polishing
- Excellent marginal adaptation for long term restorations

Presentation

Box with 50 pre-filled capsules

Product Range

N°1: 500 mg of powder - 325 mg of mercury

N°2: 700 mg of powder - 455 mg of mercury

N°3: 900 mg of powder - 585 mg of mercury



Septalloy NG 70

High silver content amalgam

CE 0459

Indications

Restoration of posterior teeth
Core build up material

Features and Benefits

- Non-gamma 2, zinc-free formulation for improved corrosion resistance
- Homogeneous dispersion phase micro-shots for improved mechanical resistance
- Contains 68.8% silver for long lasting brightness

Presentation

Box with 50 pre-filled capsules

Box with 500 pre-filled capsules

Product Range

N°1: 400 mg of powder - 440 mg of mercury

N°2: 600 mg of powder - 660 mg of mercury

N°3: 800 mg of powder - 880 mg of mercury



Composition & Physical Properties

			Securalloy	Septalloy NG 70
Composition	Alloy Composition	Ag	60 %	68.80 %
		Sn	28 %	18.50 %
		Cu	12 %	12.70 %
	Hg/powder ratio		0.65 %	1.10 %
	Mercury content		39.40 %	52.40 %
	Particle shape		Spherical	Micro-shots
	Mean particle size		< 20 µm	< 40 µm
Physical Properties	Recommended trituration time		6 seconds	6 to 8 seconds
	Working time		3.5 to 4.5 minutes	4 to 5 minutes
	Carving time		7 to 10 minutes	10 minutes
	Creep		< 1 %	< 1 %
	Compressive strength (24h)		> 400 Mpa	> 400 Mpa
	Dimensional variation		- 0.1 to + 0.2 %	- 0.1 to + 0.2 %

Restorative & Prosthetic Composites

N'Durance®

CE 0459

Nano-Dimer low shrinkage composite

Indications

Direct aesthetic restoration of both anterior and posterior teeth

Features and Benefits

- Lower volumetric shrinkage, inducing less stress on tooth-restoration interface for improved durability
- Higher intra-oral monomer conversion of 75% optimizing physical and mechanical properties and reducing elution of residual monomer
- Available in 10 Vita™ shades, Universal Opaque, Translucent, and Bleach White to offer a full colour palette, allowing superior aesthetic results
- Superior radiopacity and compressive strength of 319 MPa for long lasting posterior restorations
- Compatible with all bonding agents
- Non-sticky and easy to handle
- Extremely hydrophobic for high stain resistance
- Available in kits, single dose capsules and syringes



Presentation

Capsules Refill (20 x 0.25 g) available in each of the following shades:
A1, A2, A3, A3.5, A4, B1, B2, B3, C2, C3, Bleach White, Translucent, Universal Opaque

Syringes Refill (1 x 4.5 g) available in each of the following shades:
A1, A2, A3, A3.5, A4, B1, B2, B3, C2, C3, Bleach White, Translucent, Universal Opaque

N'Durance® Dimer Flow

Nano-Dimer low shrinkage flowable composite

CE 0459

Indications

Base/Liner	Small Cavities
Extended pit & fissure sealing	Restoration repair

Features and Benefits

- Outstanding consistency for easy placement and ideal adaptation to cavity walls
- Lower volumetric shrinkage, causing less stress on tooth-restoration interface for improved durability
- Higher intra-oral monomer conversion of 75% optimizing physical and mechanical properties and reducing elution of residual monomer
- Available in 6 Vita™ shades, Universal Opaque to offer a full colour palette, allowing superior aesthetic results
- Ultra thin syringe tips for precise placement with easy extrusion
- Compatible with all bonding agents
- Extremely hydrophobic for better colour stability

Presentation

2 x 2 g syringes, 20 tips
(shades: A1, A2, A3, A3.5, B1, C2,
Universal Opaque)

25 x syringe tips



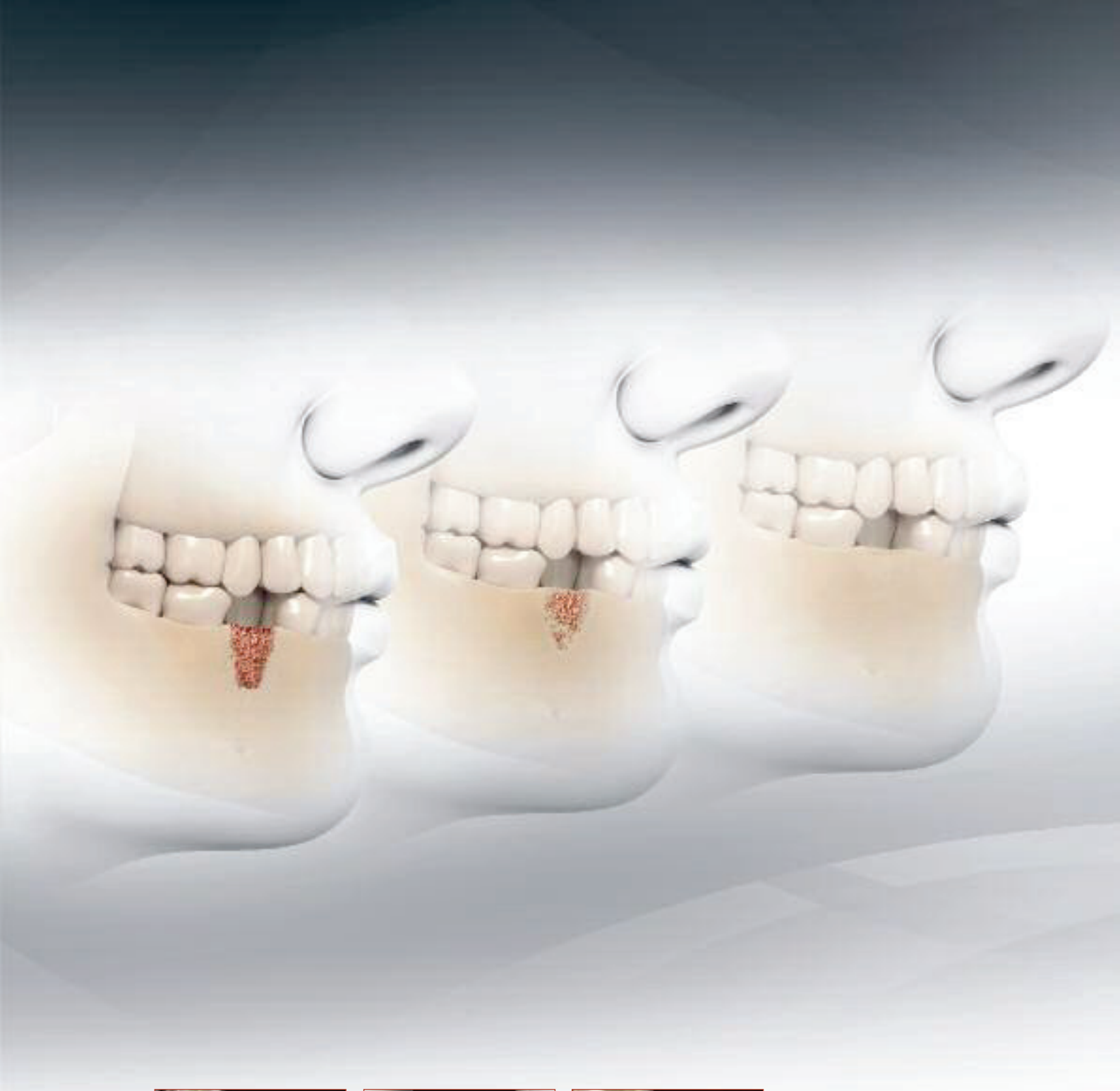

*Extraction site
filled with R.T.R.*



*Bone regeneration
with R.T.R.*



*Successful new bone growth
through full R.T.R. resorption.*

Periodontology & Surgical



R.T.R. (Resorbable Tissue Replacement) is a highly pure β -tricalcium phosphate bone grafting material that helps to safely create new bone formation following an extraction or any bone loss (intraony defect, sinus-lift...).

- **Resorbs progressively and fully**
R.T.R. releases calcium and phosphate ions helping to promote strong new bone formation.
- **Regenerates natural bone growth**
Osteoconductive micro and macroporous structures foster dense new bone growth.
- **Restores volume:** R.T.R. renews the bone integrity within 3-6 months.
- **Available in 3 presentations** (Cone, Syringe, Granules) to suit all clinical situations.

Improve your patients' extraction therapy and bone loss repair to promote future implant success with R.T.R.

34

Haemostatics

Gelopack
Hemocollagene

35

Bone treatment

R.T.R. Cone
R.T.R. Syringe
R.T.R. Granules
Alveogyl

37

Periodontology

Septocalm
Septo-Pack



Periodontology & Surgical

Haemostatics

Gelopack

CE 0459

100% purified porcine gelatin sponge



Indications

Local haemostasis after dental surgical procedures

Features and Benefits

- Sterile, insoluble in water and fully resorbable
- With a porous structure that allows the product to absorb more than 40 times its own weight of blood and fluids
- Aids in providing haemostasis and obliterating space created by teeth extractions, root amputations and removal of cysts, tumors and impacted teeth

Presentation

3 x blisters of 10 sponges
(10 x 10 x 10 mm) sterilized by gamma radiations

Hemocollagene

CE 0459

Haemostatic sponge with collagen of bovine origin

Indications

Local haemostasis after dental surgical procedures

Features and Benefits

- Individually blister-packed sterile sponges
- With collagen of bovine origin to help promote local haemostasis
- Totally resorbable to help natural regeneration of tissues
- Sponge size adapted for actual needs in dentistry

Presentation

24 x single use sponges, sterilized by beta radiations



R.T.R. Cone

β -tricalcium phosphate bone grafting material + collagen

CE 0459

Indications

Replacement of bone loss following tooth extraction, intrabony defect treatment

Bone grafting material during sinus lift procedures

Features and Benefits

- Made of β -tricalcium phosphate granules coated with a matrix of highly purified collagen fibres of bovine origin
- Sterile and gradually resorbable bone substitute
- Releases calcium and phosphate ions that help promote new bone formation
- Osteoconductive micro and macroporous structure that fosters dense new bone growth
- Helps renew bone integrity within 3-6 months



Presentation

2 x 0.3 cm³ cone in single-unit package sterilized by gamma radiation (minimal dose: 25 kGy)

R.T.R. Syringe

β -tricalcium phosphate bone grafting material

CE 0459

Indications

Replacement of bone loss following tooth extraction, intrabony defect treatment

Bone grafting material during sinus lift procedures

Features and Benefits

- Made of β -tricalcium phosphate granules of synthetic origin
- Sterile and gradually resorbable bone substitute
- Releases calcium and phosphate ions that help promote new bone formation
- Osteoconductive micro and macroporous structure that fosters dense new bone growth
- Helps renew bone integrity within 3-6 months



Presentation

0.8 cm³ curved syringe in single-unit package sterilized by gamma radiation (minimal dose: 25 kGy)

Periodontology & Surgical

Bone treatment

R.T.R. Granules

CE 0459

β -tricalcium phosphate bone grafting material



Indications

Replacement of bone loss following tooth extraction, intrabony defect treatment

Bone grafting material during sinus lift procedures

Features and Benefits

- Made of β -tricalcium phosphate granules of synthetic origin
- Sterile and gradually resorbable bone substitute material
- Releases calcium and phosphate ions to help promote new bone formation
- Osteoconductive micro and macroporous structure that fosters dense new bone growth
- Helps renew bone integrity within 3-6 months
- Conveniently packaged in bulk (2 cm³) specially adapted to treatment of large defects or sinus lift procedures

Presentation

1 bottle containing 2 cm³ granules in single-unit package sterilized by gamma radiation (minimal dose: 25 kGy)

Alveogyl

CE 0459

Eugenol impregnated alveolar dressing

Indications

Dry socket dressing

Features and Benefits

- With a fibrous consistency thanks to Penghawar fibres for an easy filling of the socket and a good adherence to the alveolus
- Provides a soothing effect on the alveolar tissues thus helping to rapidly alleviate the pain
- Convenient and easy-to-use: Alveogyl is a one step, self-eliminating treatment requiring no suturing and no special attention other than observation of the healing process
- May also be used as post-extraction dressing in patients with history of dry sockets



Presentation

10 g jar

Septocalm

Topical cauterisation agent

CE

Indications

Cauterisation of tissue ulcers, canker sores

Features and Benefits

- 35% trichloroacetic acid aqueous solution with caustic effect
- Immediate relief of patient's pain
- Accelerates natural healing process by promoting regeneration of damaged oral mucous membranes

Presentation

13 ml bottle



Septo-Pack

Occlusive gingival dressing

CE 0459



Indications

Protective gingival dressing after localized periodontal treatment

Temporary dressing (gingival retraction before cervical caries restoration)

Features and Benefits

- Self-hardening paste for an easy placement in cavity
- Can be used as a neutral medium to bring local medication to dental and periodontal tissues
- Easy removal thanks to its consistency after setting

Presentation

60 g jar





Impression



Racegel is a gingival gel, specifically designed to make your gingival preparation procedures easier and more comfortable for your patients while ensuring the quality and precision of your impressions.

Racegel is easy to place and passively contracts the gingival tissue making impression taking easy and accurate.

Its thermal reactive properties slightly open the sulcus. It can be used with or without retraction cord. The concentration of aluminium chloride (25 %) effectively provides superior hemostasis while its orange colour is easy to identify and rinses away with just water. Its simple syringe system allows for precise placement without the use of a dispensing gun.

Racegel is used for any procedure where control of gingival tissue is necessary including impressions, seating restorations, preparing class II, III & V restorations.

40

Gingival Preparation

Racegel
Racestypine Cord N
Racestypine Solution
Septofil

42

Impression Materials

Perfexil
Plastalgin



Impression

Gingival preparation

Racegel

CE

Thermogelifiable gel for gingival preparation



Presentation

3 x 1.4 g syringe + 30 pre-bent tips

Indications

Sulcus preparation and control of bleeding prior to impression taking and in the preparation of Class II, III and V cavities

Features and Benefits

- Thermogelifiable properties to ensure no mechanical trauma to the periodontium, to control application without excessive hand pressure and to facilitate placement and rinsing: Racegel does not run or drip
- 25% Aluminium Chloride for optimal and fast control of bleeding and gingival oozing
- Orange colour to easily visualise Racegel during placement and rinsing.
- Thin, pre-bent needle tips for better placement even in hard-to-reach areas
- Raspberry aroma for patient comfort

Racestyptine Cord N

CE

Impregnated cord for gingival retraction

Indications

Gingival retraction before taking impression and minor gingival hemorrhages

Features and Benefits

- Temporary and immediate gingival retraction for impression taking and certain surgery procedures
- Braided cord to improve the mechanical effect on the gingiva
- Impregnated with an astringent solution containing aluminium and potassium sulfate
- Stops gingival bleeding and exudation of the mucosa

Presentation

Bottle n.° 0 (thin cord)

Bottle n.° 1 (medium cord)



Racestyptine Solution

Solution for gingival retraction

CE

Indications

Complements mechanical action of retraction cord before impression taking

Features and Benefits

- Contains aluminium chloride for a gentle astringent effect and excellent haemostatic properties
- Precipitates tissular and serum proteins, inducing local haemostasis and contraction of upper strata of free gingiva

Presentation

13 ml bottle, pipette



Septofil

Non impregnated knitted cord

CE



Indications

Retraction of free gingiva during tooth preparation, restoration try-ins, impression taking and final cementation or bonding

Features and Benefits

- Cotton cord available in 4 different thicknesses to fulfill every clinical situations
- Knitted design to improve mechanical effect on the free gingiva
- Improved absorption capacity for an astringent solution

Presentation

Ultra-thin cord (Ø 0.5 mm, 2.5 m)

Thin cord (Ø 0.6 mm, 2.5 m)

Medium cord (Ø 0.8 mm, 2.5 m)

Thick cord (Ø 1.0 mm, 2.5 m)

Impression

Impression materials

Perfexil



A-Silicone impression materials



Indications









Highly stable and accurate impression of dental and oral structures for prosthodontics

Features and Benefits

- Vinyl Polysiloxane Silicones with an addition-type polymerization reaction
- Hydrophilic, thus reducing the risk of bubble and voids formation
- Optimum flowing property into subgingival area thanks to the thixotropy of the material
- Range of 9 products, allowing to perform every impression techniques

Technical Characteristics

Presentation

Viscosity	Products		ISO 4823 ADA 19	Oral setting time (min.)	Total setting time	Strain in compression (min-max)	Shore-A hardness	Presentation
Putty	Hard		Type 0 Putty Consist.	3 min. 30 sec	5 min. 30 sec	1-3%	70+/-2	280 ml jar of base 280 ml jar of catalyst
	Soft		Type 0 Putty Consist.	3 min. 30 sec	5 min. 30 sec	1-3%	60+/-2	
	Soft Fast set		Type 0 Putty Consist.	2 min. 30 sec	4 min.	1-3%	60+/-2	
	Super Soft Fast set		Type 0 Putty Consist.	2 min. 30 sec	4 min.	1-3%	60+/-2	
Medium	Tray material		Type 1 Heavy-bodied Consist.	2 min. 30 sec	4 min.	3-5%	60+/-2	2 x 380 ml cartridges, 2 x locking rings, 20 x dynamic mixing tips
	Regular		Type 2 Medium-bodied Consist.	3 min. 30 sec	5 min. 30 sec	3-5%	45+/-2	2 x 50 ml cartridges, 12 mixing tips
Light	Light		Type 3 Light-bodied Consist.	3 min. 30 sec	5 min. 30 sec	3-5%	45+/-2	2 x 50 ml cartridges, 12 mixing tips
	Super Light		Type 3 Light-bodied Consist.	3 min. 30 sec	5 min. 30 sec	3-5%	45+/-2	
	Light Fast set		Type 3 Light-bodied Consist.	2 min. 30 sec	4 min.	3-5%	45+/-2	

Plastalgin

Alginate impression material

CE

Indications

Accurate impression for case study and orthodontic models, fabrication of models for mouthguards, provisional restorations, bleaching trays, partial denture frameworks and occlusal splint appliances

Features and Benefits

- Available both for “normal” setting (Plastalgin) and “quick” setting (Plastalgin Fast) to adapt to different clinical situations
- Class A alginates for accurate impressions
- Naturally hydrophilic for an easy mix and excellent wettability of oral tissues
- Quick and easy to mix without bubbles and inconsistencies
- Patient and user-friendly, Apple-flavoured (Plastalgin) or Apricot-flavoured (Plastalgin Fast)
- Dust-free formula



Properties

	PLASTALGIN	PLASTALGIN FAST
Mixing time	45"	30"
Total working time	2'15"	1'15"
Setting time	3'10"	1'45"
Viscosity	38 mm	36 mm
Reproduction of details	20 µ	20 µ
Compression strain	12.5 %	12.5 %

Presentation

454 g bag





Preventive Care

Detartine is a range of superior prophylaxis pastes for professional tooth cleaning and polishing procedures.

- **Detartine allows you to meet all clinical situations**

Detartine is available in 2 different abrasive values with defined RDA (Relative Dentine Abrasion): 150, 100, and in fluoride-containing and fluoride-free formulations:

- **Detartine 150Z:** Coarse (RDA 150) - is ideal for initial polishing and patients with substantial stain build-up
- **Detartine 100ZF:** Medium (RDA 100) - is suitable for most cleaning procedures where high level of polish is desired while contributing to remineralization of dental surfaces

- **Detartine is now available in tubes** - for more hygienic and accurate dispensing

46

Oral Hygiene

Calypso

46

Tooth Protection

Isodan

47

Scaling & Polishing

Detartine / Detartine Z
Detartine 100ZF / 150Z



Preventive Care

Oral hygiene & Tooth Protection

Calypso

Flavoured Mouthwash

CE



Indications

Mouthwash solution prior or during dental procedures

Features and Benefits

- Helps to prepare operatory field
- Ensures elimination of debris and blood during treatment
- Gives patient sensation of freshness between stages of dental work
- Available in 3 different fruit flavours for patient's choice
- Comes in concentrated form that dissolves immediately in water

Presentation

3 x bottle of assorted flavours

3 x bottle of 500 ml mint flavour

3 x bottle of 500 ml orange flavour

3 x bottle of 500 ml raspberry flavour

Isodan

Desensitizing solution

CE 0459

Indications

Treatment of dentinal hypersensitivity

Features and Benefits

- Clinically proven, long term relief for patient
- Forms a barrier within the dentine tubules and prevents movement of the intratubular fluid
- Contains sodium fluoride which reinforces enamel/dentine barrier
- With HEMA acting as a wetting agent, which contributes to homogeneous diffusion of Isodan
- Can be used under restorations

Presentation

5 ml bottle, 20 x application brushes

Application of Isodan induces closure of dentinal tubules

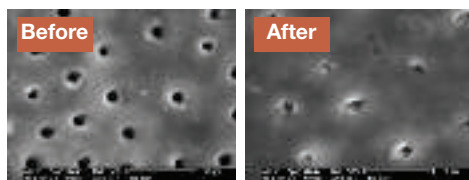

Preventive Care

Scaling & Polishing

Detartrine / Detartrine Z

Dental paste for scaling

CE

Indications

Polishing after scaling and root planning
Polishing of fillings and dental surfaces
Detartrine Z: removing of drink, food and tobacco stainings

Features and Benefits

- Mechanical abrasive action due to the presence of silica
- Pleasant taste and feeling of freshness thanks to the essential oils
- Available in 2 grit sizes: fine and coarse to meet all clinical needs
- Detartrine Z contains Zircon powder for an improved efficiency against difficulty to remove stainings

Presentation

45 g jar



Detartrine 100ZF / 150Z

Prophylaxis paste

CE



Presentation

1 x 65 ml tube

30 x FixyDap™

Indications

Prophylaxis treatment after scaling
Elimination of drink, food and tobacco stains
Polishing of dental surfaces

Features and Benefits

- Available in 2 abrasion levels to meet all clinical situations: coarse (RDA 150), medium (RDA 100)
- Available in both fluoride-containing and fluoride free formulations
- Detartrine 150Z - contains Zirconium - Ideal for initial polishing & patients with substantial stain build up
- Detartrine 100ZF - contains both Zirconium and Fluoride - Suitable for most cleaning procedures where high level of polish is desired while contributing to remineralization of dental surfaces
- Available in tubes for more hygienic and accurate dispensing
- Can be used with **FixyDap™**: an easy-to-use prophylaxis paste holder, with built-in self adhesive base for attachment to the glove or to the tray



Infection Control



Epicrem is the solution to protect your hands!

- Non-greasy cream.
- Specially formulated to protect the skin.
- Pleasantly scented.
- Penetrates easily, leaves no greasy residus and forms an effective barrier against the irritating components of your gloves without affecting their integrity.

50

Instrument Disinfection

Quitamet Plus
Rotagerm

51

Hand Hygiene & Disinfection

Epicrem
Sapofilm

52

Impression Disinfectant

Dimenol Spray



Infection Control

Instrument Disinfection

Quitamet Plus

CE 0459

Concentrated cleaning and disinfection solution for dental instruments



Medical Device - Class IIb

Indications

Instrument cleaning and disinfection

Features and Benefits

- Economical to use: the diluted (2%) solution remains active for 24 hours
- Can be used in a soaking tank and in ultra-sonic tank
- Bactericidal in 10 min, 1%, 20°C: EN 1040, EN 13727, EN 14561
- Yeastocidal in 10 min, 2%, 20°C: EN 1275, EN 13624 and EN 14562
- Tuberculocidal in 30 min, 2%, 20°C: EN 14563
- Active against HIV – 1, Herpes virus and PRV (surrogate of HCV) in 5 min, 0.1%, 20°C, against BVDV (surrogate of HCV) in 10 min, 0.25%, 20°C and against Influenza virus A [H1N1] in 5 min, 0.75%, 20°C

Instructions for use



Presentation

2 x 1ltr dosing bottle

Rotagerm

CE 0459

Cleaning and disinfection solution for burs



Indications

Cleaning and disinfection of burs

Features and Benefits

- Bactericidal in 15 min: EN 1040, EN 13727, EN 14561
- Active against Mycobacterium tuberculosis (BK) in 15 min
- Yeastocidal in 15 min: EN 1275, EN 13624, EN 14562
- Active against HIV-1, HBV, Herpes virus and BVDV (HCV-like virus) in 5 min

Presentation

2 ltr bottle



Medical Device - Class IIb

Epicrem

Non-greasy hand cream

Indications

Hand protection

Features and Benefits

- Protects the skin spoilt by frequent wear of gloves
- Non-greasy cream with delicate perfume
- Penetrates easily to ensure effective protection of the epidermis
- Will not affect the integrity of latex gloves

Presentation

100 g tube



Cosmetic

Sapofilm

Hand soap base



Cosmetic

Indications

Hand washing

Features and Benefits

- Specially formulated for very frequent hand washing
- Ensures perfect cleaning while softening and film-forming agents allow a protective film to remain on skin after rinsing
- Contains preservative agents to maintain microbiological cleanliness of Sapofilm once bottle has been opened

Presentation

3 x 980 ml bottles with 2 x dispensing pumps

Infection Control

Impression Disinfection

Dimenol Spray

CE 0459

Disinfection solution for impressions



Medical Device - Class IIa

Indications

Disinfection of impression materials (alginate, silicone)

Features and Benefits

- No significant effect on dimensional stability of impressions
- Compatible with casting materials
- Bactericidal: NF EN 13727
- Yeastidal: NF EN 13624
- Virucidal: active against HIV-1 according to NF T 72-180

Presentation

200 ml spray bottle

LIGNOSPAN SPECIAL 2%

COMPOSITION: Lidocaine 2%, Adrenaline (Epinephrine) 1:80,000. THERAPEUTIC INDICATIONS: Local anaesthesia for dental procedures by infiltration or nerve block injections. DOSAGE AND ADMINISTRATION: The lowest dosage that results in effective anaesthesia should be used. Adults: 1 cartridge is generally sufficient. Do not exceed 3 cartridges. Adolescents (from 14 to 17) and the elderly: usual dose 1.8 ml. Do not exceed 3.6 ml. Children (from 6 to 14): usual dose 1.35 ml. Do not exceed 2.7 ml. Children (from 3 to 6): 0.9 to 1.8 ml. CONTRA-INDICATIONS: Not for patients with known hypersensitivity to amide anaesthetics or to any component. Not for patients suffering from: arterial hypertension, coronary disease, vascular cardiac disease. Do not use under 3 years of age. SPECIAL WARNINGS AND PRECAUTIONS FOR USE: For professional dental use only. Use with caution in patients with peripheral vascular disease or hepatic disease. Resuscitative equipment, oxygen and other resuscitative drugs should be available for immediate use. Use with caution during early pregnancy or in nursing women. Do not inject into a blood vessel. Perform aspiration before injection. Inject slowly. Use with caution in case of local inflammation and/or sepsis. The cartridge is for single use only. INTERACTIONS: Avoid concomitant use with MAOI, with tricyclic antidepressants or with phenothiazines. Concomitant use of vasopressor drugs and ergot-type oxytocic drugs may cause severe, persistent hypertension or cerebrovascular accidents. Reduce doses of anaesthetic in case of concomitant use with sedatives. Concomitant use of beta-adrenergic blocking agents may result in hypertension and bradycardia. UNDESIRABLE EFFECTS: Excitatory and/or depressant manifestations of the CNS, depressant cardiovascular manifestations and allergic reactions. PHARMACEUTICAL PRECAUTIONS: Store in the original package, in a dry place below 25°C and protect from light. Do not freeze. PHARMACEUTICAL FORM: Solution for injection - 1.8 and 2.2 ml cartridges. LEGAL CATEGORY: POM. FOR FURTHER INFORMATION CONTACT THE PRODUCT LICENCE HOLDER: SEPTODONT LIMITED, Units R&S, Orchard Business Centre, St Barnabas Close, Allington, Maidstone, Kent ME160JZ, UK. PL 08313/0019 Available from your licensed dental wholesaler. Further information and SmPC available upon request.

SCANDONEST 2% SPECIAL

COMPOSITION: Mepivacaine 2%, Adrenaline (Epinephrine) 1/100,000. THERAPEUTIC INDICATIONS: Local anaesthesia for dental procedures by infiltration or nerve block injections. DOSAGE AND ADMINISTRATION: The lowest dosage that results in effective anaesthesia should be used. Adults: 1 cartridge for routine work. Do not exceed 3 cartridges. Children (from 6 to 14): usual

dose 1.6 ml. Do not exceed 3.3 ml. Children (from 3 to 6): 1.1 to 2.2 ml. CONTRA-INDICATIONS: Not for patients allergic to amide anaesthetics or to any component. Not for patients suffering from: arterial hypertension, coronary disease, valvular affection or under MAOI or tricyclic antidepressant treatment. Do not use under 3 years of age. SPECIAL WARNINGS AND PRECAUTIONS FOR USE: For professional dental use only. Use with caution in patients with peripheral vascular disease, hepatic disease, renal disease, a history of disturbances of cardiac rhythm or heart block, epilepsy or impaired respiratory function. Resuscitative equipment, oxygen and other resuscitative drugs should be available for immediate use. Use with caution during early pregnancy or in nursing women. Do not inject into a blood vessel. Perform aspiration before injection. Inject slowly. Use with caution in case of local inflammation and/or sepsis. The cartridge is for single use only. Do not inject repeatedly at the same site. INTERACTIONS: Avoid concomitant use with phenothiazines, vasopressor drugs and ergot-type oxytocic drugs, beta-adrenergic drugs and chloroform, halothane, cyclopropane, trichloroethylene, or other related agents. Reduce doses of anaesthetic in case of concomitant use with sedatives. UNDESIRABLE EFFECTS: Excitatory and/or depressant manifestations of the CNS, depressant cardiovascular manifestations and allergic reactions. PHARMACEUTICAL PRECAUTIONS: Store in the original package, in a dry place below 25°C and protect from light. PHARMACEUTICAL FORM: Solution for injection - 1.8 and 2.2 ml dental cartridges. LEGAL CATEGORY: POM. FOR FURTHER INFORMATION CONTACT THE PRODUCT LICENCE HOLDER: SEPTODONT LIMITED, Units R&S, Orchard Business Centre, St Barnabas Close, Allington, Maidstone, Kent ME160JZ, UK. PL 08313/0026 Available from your licensed dental wholesaler. Further information and SmPC available on request

SCANDONEST 3% PLAIN

COMPOSITION: Mepivacaine hydrochloride 3%. THERAPEUTIC INDICATIONS: Local anaesthesia for dental and chiropody procedures. DOSAGE AND ADMINISTRATION: - in dentistry: The lowest dosage that results in effective anaesthesia should be used. Adults 1 cartridge for routine work. Do not exceed 3 cartridges. Children from 4 years of age and older: recommended dose: 0.025 ml / kg body weight. Do not exceed 0.1 ml / kg body weight. - in chiropody: Adults 2.2 to 4 ml. Do not exceed 4.4 ml / digit and 6 mg / kg body weight / 24h. CONTRA-INDICATIONS: Not for patients allergic to amide anaesthetics. Do not use under 4 years of age. SPECIAL WARNINGS AND PRECAUTIONS FOR USE: For professional dental use only. Use with caution in patients with hepatic disease, renal disease, a history of disturbances of cardiac rhythm or heart block.

Resuscitative equipment, oxygen and other resuscitative drugs should be available for immediate use. Use with caution during early pregnancy or in nursing women. Do not inject into a blood vessel. Perform aspiration before injection. Inject slowly. Use with caution in case of local inflammation and/or sepsis. The cartridge is for single use only. INTERACTIONS: Reduce doses of anaesthetic in case of concomitant use with sedatives. UNDESIRABLE EFFECTS: Excitatory and/or depressant manifestations of the CNS, depressant cardiovascular manifestations and allergic reactions. PHARMACEUTICAL PRECAUTIONS: Store in the original package, in a dry place below 25°C and protect from light. PHARMACEUTICAL FORM: Solution for injection - 1.8 and 2.2 ml dental cartridges. LEGAL CATEGORY: POM. FOR FURTHER INFORMATION CONTACT THE PRODUCT LICENCE HOLDER: SEPTODONT LIMITED, Units R&S, Orchard Business Centre, St Barnabas Close, Allington, Maidstone, Kent ME160JZ, UK. PL 08313/0023 Available from your licensed dental wholesaler. Further information and SmPC available on request.

SEPTANEST 1:100,000

Articaine 4%, Adrenaline (Epinephrine) 1:100,000. THERAPEUTIC INDICATIONS: Local or loco-regional dental anaesthesia in case of classic procedures, mucogingival procedures or dental surgical procedures where bone removal is necessary. DOSAGE AND ADMINISTRATION: For adults, for most common procedures, one infiltration with 1.7 ml is sufficient. For infiltration in the interdental septum, 0.3 to 0.5 ml is generally sufficient. Do not exceed 7 mg articaine per kilo of weight. For children aged 4 years and older, dosage should be commensurate with their weight. The recommended dose in 20 kg child is about ¾ cartridge of 1.7 ml or ½ cartridge of 2.2 ml (do not exceed 3.5 ml). The recommended dose in 40 kg child is about 1.5 cartridge of 1.7 ml or 1 cartridge of 2.2 ml (do not exceed 7 ml). CONTRA-INDICATIONS: Hypersensitivity to any local anaesthetic agent or to any component. Not for patients who have experienced bronchospasms following administration of products containing sulphites. Not for patients with deficiency in plasma cholinesterase activity. Not for patients receiving MAOI or tricyclic antidepressants. Not for patients in whom general anaesthesia might be required. Do not use under 4 years of age. SPECIAL WARNINGS AND PRECAUTIONS FOR USE: Use with caution in case of deficiency in plasma cholinesterase activity, of hepatic disease, of thyrotoxicosis, of cardiovascular disease, of abnormalities of cardiac conduction, of epilepsy, or of diabetes. Intravascular injection is strictly contra-indicated. In case of local inflammation and/or sepsis, anaesthetic effects may be reduced. Use during pregnancy only when the benefits are considered to outweigh the risks. Breastfeeding should

be avoided 48 hours following administration. Verbal contact should be maintained and resuscitative equipment should be at hand. **INTERACTIONS:** Use with caution in patients receiving drugs with sympathomimetic properties or with agents whose therapeutic actions may be antagonised by adrenaline. Articaine should be given with caution in patients receiving an antiarrhythmic agent. **ABILITY TO DRIVE AND USE MACHINES:** Subjects who suffer adverse effects should not drive or use machines until symptoms have resolved. **UNDESIRABLE EFFECTS:** Excitatory or depressant manifestations of the CNS, depressant cardio-vascular reactions, respiratory and allergic reactions. Patients with peripheral or hypertensive vascular disease may develop ischemic injury or necrosis. If signs of acute toxicity are suspected, stop injection, administer oxygen (by assisted ventilation if necessary) and change patient to supine position if necessary. In case of cardiac arrest, immediately initiate cardiopulmonary resuscitation. **PHARMACEUTICAL PRECAUTIONS:** Store in the original container, below 25°C. Protect from light. **PHARMACEUTICAL FORM:** Solution for injection - 1.7 ml and 2.2 ml cartridges. **LEGAL CATEGORY:** POM. FOR FURTHER INFORMATION CONTACT THE PRODUCT LICENCE HOLDER: SEPTODONT LTD, Units R&S, Orchard Business Centre, St Barnabas Close, Allington, Maidstone, Kent ME160JZ, UK. PL 08313/0039 Available from your licensed dental wholesaler. Further information and SmPC available upon request.

SEPTANEST 1:200,000

COMPOSITION: Articaine 4%, Adrenaline (Epinephrine) 1:200,000. **THERAPEUTIC INDICATIONS:** For dental anaesthesia only. Local or loco-regional dental anaesthesia in case of classic procedures or muco-gingival procedures. **DOSAGE AND ADMINISTRATION:** For Adults, for most common procedures, one infiltration with 1.7 ml is sufficient. For infiltration in the interdental septum, 0.3 to 0.5 ml is generally sufficient. Do not exceed 7 mg articaine per kilo of weight. For children aged 4 years and older, dosage should be commensurate with their weight. The recommended dose in 20 kg child is about ¾ cartridge of 1.7 ml or ½ cartridge of 2.2 ml. (do not exceed 3.5 ml). The recommended dose in 40 kg child is about 1.5 cartridge of 1.7 ml or 1 cartridge of 2.2 ml (do not exceed 7 ml). **CONTRA-INDICATIONS:** Hypersensitivity to any local anaesthetic agent or to any component. Not for patients who have experienced bronchospasms following administration of products containing sulphites. Not for patients with deficiency in plasma cholinesterase activity. Not for patients receiving MAOI or tricyclic anti-depressants. Not for patients in whom general anaesthesia might be required Do not use under 4 years of age. **SPECIAL WARNINGS AND PRECAUTIONS FOR USE:** Use with caution in case of deficiency in plasma cholinesterase

activity, of hepatic disease, of thyrotoxicosis, of cardiovascular disease, of abnormalities of cardiac conduction, of epilepsy or of diabetes. Intra-vascular injection is strictly contra-indicated. In case of local inflammation and/or sepsis, anaesthetic effects may be reduced. Use during pregnancy only when the benefits are considered to outweigh the risks. Breastfeeding should be avoided 48 hours following administration. Verbal contact should be maintained with the patient and resuscitative equipment should be at hand. **INTERACTIONS:** Use with caution in patient receiving drugs with sympathomimetic properties or with agents whose therapeutic actions may be antagonised by adrenaline. Articaine should be given with caution in patients receiving an antiarrhythmic agent. **ABILITY TO DRIVE AND USE MACHINES:** Subjects who suffer adverse effects should not drive or use machines until symptoms have resolved. **UNDESIRABLE EFFECTS:** Excitatory or depressant manifestations of the CNS, depressant cardio-vascular reactions, respiratory and allergic reactions. Patients with peripheral or hypertensive vascular disease may develop ischemic injury or necrosis.. If signs of acute toxicity are suspected, stop injection, administer oxygen (by assisted ventilation if necessary) and change patient to supine position if necessary. In case of cardiac arrest, immediately initiate cardiopulmonary resuscitation. **PHARMACEUTICAL PRECAUTIONS:** Store in the original container below 25°C. Protect from light. **PHARMACEUTICAL FORM:** Solution for injection - 1.7ml and 2.2 ml cartridges. **LEGAL CATEGORY:** POM. FOR FURTHER INFORMATION CONTACT THE PRODUCT LICENCE HOLDER: SEPTODONT LTD, Units R&S, Orchard Business Centre, St Barnabas Close, Allington, Maidstone, Kent ME160JZ, UK. PL 08313/0038 Available from your licensed dental wholesaler. Further information and SmPC available on request.

XYLONOR GEL 5%

COMPOSITION: Lidocaine 5 %, Cetrimide 0.15 %. **THERAPEUTIC INDICATIONS:** Topical anaesthesia in the buccal cavity. **DOSAGE AND ADMINISTRATION:** Local use. Apply 0.1 - 0.5 g with a cotton pellet. The lowest dose resulting in effective anaesthesia should be used. Dosage should always be adapted to the physical state of the patient. **CONTRA-INDICATIONS:** Not for patients with history of hypersensitivity to amide anaesthetics, to cetrimide or to any other component. Do not use under 3 years of age. **SPECIAL WARNINGS AND PRECAUTIONS FOR USE:** Use with caution in case of sepsis or of extremely traumatised mucosa in the area of application. Use with caution in patients with known drug sensitivities. Patients should neither eat nor chew until they have recovered normal sensitivity. Results on doping tests performed on sportsmen may be positive. Use with caution during early pregnancy or in nursing women.

INTERACTIONS: soaps and amionic surfactants are known to decrease the bactericidal activity of cetrimide. **UNDESIRABLE EFFECTS:** systemic adverse reactions are extremely rare with lidocaine ointments. However, hypersensitivity, overdose or diminished tolerance may result in excitatory and/or depressant CNS manifestations, in depressant cardiovascular and respiratory system manifestations and/or in allergic reactions. **PHARMACEUTICAL PRECAUTIONS:** Keep well-closed below 25°C. **PHARMACEUTICAL FORM:** Gel (tube: 15 g). **LEGAL CATEGORY:** P. FOR FURTHER INFORMATION CONTACT THE PRODUCT LICENCE HOLDER: SEPTODONT LIMITED, Units R&S, Orchard Business Centre, St Barnabas Close, Allington, Maidstone, Kent ME160JZ, UK. PL 08313/0027. Available from your licensed dental wholesaler. Further information and SmPC available upon request.

XYLONOR SPRAY

COMPOSITION: per metered dose: lidocaine 10.00 mg, cetrimide 0.10 mg **THERAPEUTIC INDICATIONS:** Topical anaesthesia and disinfection of the mucous membrane in the buccal cavity. **DOSAGE AND ADMINISTRATION:** The lowest dose resulting in effective anaesthesia should be used. Dosage should always be adapted to the physical state of the patient. One metered dose (10 mg) is usually sufficient. The maximum single dose is 20 mg. Up to 5 sites may be treated simultaneously, though no more than 3 in each quadrant, and only one quadrant should be anaesthetised during one sitting. **CONTRAINDICATIONS:** Not for patients with history of hypersensitivity to amide anaesthetics, to cetrimide or to any other component. Do not use under 3 years of age. **SPECIAL WARNINGS AND PRECAUTIONS FOR USE:** Use with caution in case of sepsis or of extremely traumatised mucosa in the area of application. Use with caution in patients with known drug sensitivities. Avoid spraying back of throat or mouth. Use with caution during early pregnancy or in nursing women. **INTERACTIONS:** Beta adrenergic blocking agents and cimetidine may slow the metabolism of lidocaine and increase the risk of toxicity. **UNDESIRABLE EFFECTS:** Excitatory and/or depressant CNS manifestations, depressant cardiovascular and respiratory system manifestations and/or allergic reactions. **PHARMACEUTICAL PRECAUTIONS:** store below 25°C. **PHARMACEUTICAL FORM:** metered aerosol (flask: 36 g). **LEGAL CATEGORY:** POM. FOR FURTHER INFORMATION CONTACT THE PRODUCT LICENCE HOLDER: SEPTODONT LIMITED, Units R&S, Orchard Business Centre, St Barnabas Close, Allington, Maidstone, Kent ME160JZ, UK. PL 08313/0032 Available from your licensed dental wholesaler. Further information and SmPC available upon request.

Alveogyl	p 36	Parcan	p 18
Biodentine™	p 23 & 26	Perfexil	p 42
BioRoot™ RCS	p 20	Pharmaethyl	p 08
Calcipulpe	p 27	Plastalgin	p 43
Calypso	p 46	Quitamet Plus	p 50
Canal +	p 18	R.T.R. Cone	p 35
Cimpat LC	p 27	R.T.R. Granules	p 36
Cimpat N/Cimpat Pink	p 27	R.T.R. Syringe	p 35
Cimpat S	p 28	R4	p 19
Detartrine / Detartrine Z	p 47	Racegel	p 40
Detartrine 100ZF / 150Z	p 47	Racestyptine Cord N	p 40
Dimenol Spray	p 53	Racestyptine Solution	p 41
Endocal	p 19	Rotagerm	p 50
Endomethasone N/Endomethasone Liquid	p 21	Sapofilm	p 51
Endomet Plain	p 21	Scandonest 2% Special	p 10
Endoperox Kit	p 23	Scandonest 3% Plain	p 10
Endosolv E	p 22	Securalloy	p 28
Endosolv R	p 22	Septalloy NG 70	p 29
Epicrem	p 51	Septanest 1:100,000	p 09
Gelopack	p 34	Septanest 1:200,000	p 09
Hemocollagene	p 34	Septocalm	p 37
Isodan	p 46	Septofil	p 41
Largal Ultra	p 18	Septoject	p 12
Lignospan Special	p 11	Septoject Evolution	p 14
N'Durance®	p 30	Septoject XL	p 13
N'Durance® Dimer Flow	p 31	Septo-Pack	p 37
		Ultra Safety Plus	p 15
		Xylonor Gel	p 08
		Xylonor Spray	p 08



Septodont Limited

Units R & S, Orchard Business Centre
St Barnabas Close, Allington
Maidstone, Kent ME16 0JZ,
UNITED KINGDOM

Tel.: 01622 695520
www.septodont.co.uk

Septodont Headquarters

58, rue du Pont de Créteil
94107 Saint-Maur Cedex
FRANCE

2016

