

Foundation - ways of assembly

1) Assembly on playground with powder type safe surface (eg. sand)

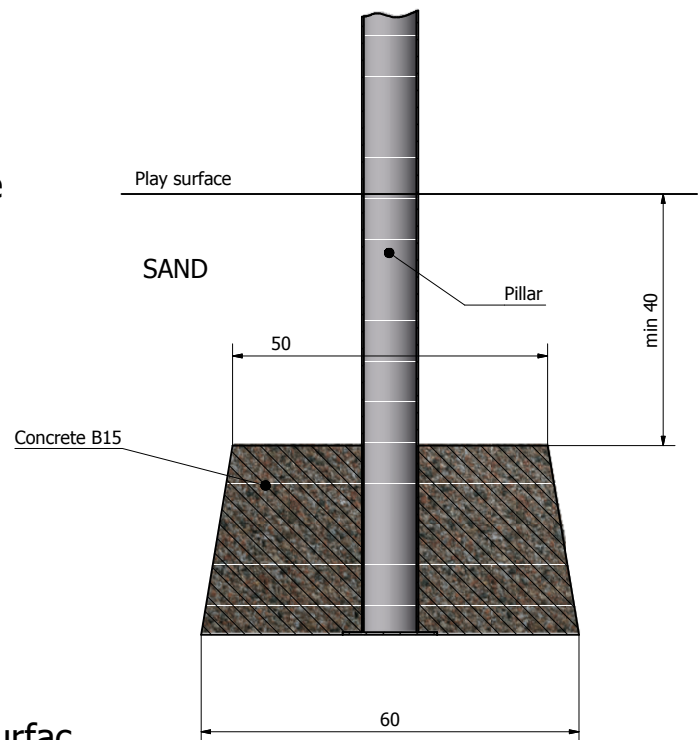

2) Assembly on playground with synthetic surfac

a) Assembly in concrete with use of flanges and chemical anchors.

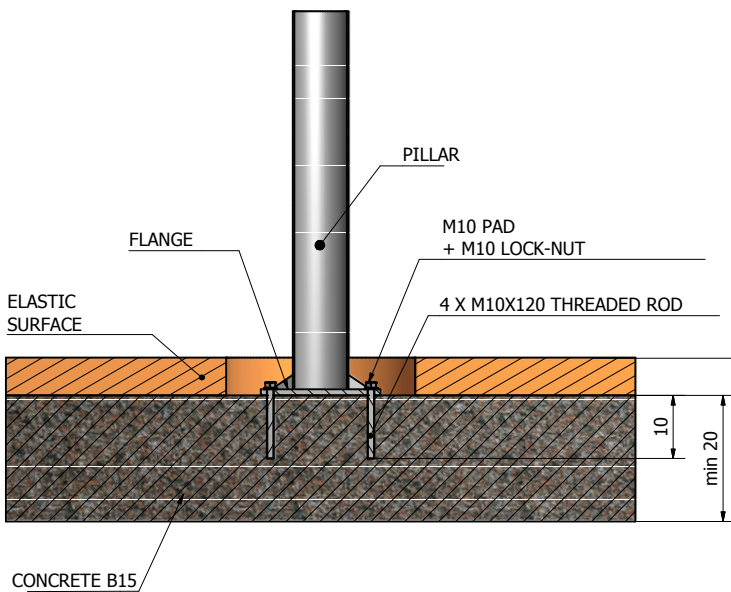

ASSEMBLY ORDER

- 1) On prepared concrete surface in anchor mount place drill holes with 100mm depth and 12mm diameter.
- 2) Clean the holes and enter two component anchor.
- 3) With spiral moves press the rods until they resist.
- 4) Leave it for 2 hours.
- 5) Tighten the pillar using nod glue (like loctite)
- 6) Cut all protruding rod ends.
- 7) Cover the mounting with elastic suface.

b) Assembly with use of flashed foundations

